



Timber Frame Solutions LLC

TRANSFORMING  
TIMBERS  
TRANSCENDING  
EXPECTATIONS

Pre-cut. Pre-fit. Ready to Raise



[www.timberframesolutionsllc.com](http://www.timberframesolutionsllc.com)

# ABOUT US

**Timber Frame Solutions produces high-quality post-and-beam timber structures crafted from locally sourced cypress and Southern Yellow Pine. Our precision-milled timbers are joined using engineered steel connector systems, delivering both structural integrity and clean aesthetics.**

**We specialize in trusses, complete pavilion packages, and custom steel fabrication. Headquartered in Henderson, Tennessee, we serve clients across the country.**



## WHAT SETS US APART?

**We design custom timber structures that seamlessly balance form and function. Each kit is precision pre-cut, pre-drilled, and pre-fit to streamline installation, with all necessary hardware included (excluding anchors and decking fasteners).**

**Our process reduces build time for both homeowners and contractors while providing direct, one-on-one support from a team committed to craftsmanship and quality.**

# STANDARD PAVILION KITS

| Sizes | Cypress Kits | Pine Kits | Stain Add-On | Roofing Add-On | Plating Add-On |
|-------|--------------|-----------|--------------|----------------|----------------|
| 12x16 | \$11,520     | \$9,600   | \$1,200      | \$1,500        | \$1,800        |
| 12x20 | \$14,400     | \$12,000  | \$1,500      | \$1,900        | \$2,900        |
| 16x20 | \$19,200     | \$16,000  | \$2,000      | \$2,500        | \$2,900        |
| 16x24 | \$23,040     | \$19,200  | \$2,400      | \$2,900        | \$2,900        |
| 20x20 | \$24,000     | \$20,000  | \$2,500      | \$3,200        | \$2,900        |
| 20x30 | \$36,000     | \$30,000  | \$3,700      | \$4,500        | \$3,800        |
| 24x40 | \$57,600     | \$48,000  | \$5,800      | \$6,300        | \$4,800        |

## **Base Package & Notes**

*Base kits include structural materials only. Stain, roofing, engineering, and steel plating are add-ons.*

*Standard sizing applies up to 24' x 40'. Larger structures require custom quote and engineering.*

## **Standard Materials:**

*4x7 Trusses & Rafters | 4x7 Knee Braces | 8x8 Posts | 5x12 Headers | 2x8 T&G Decking*

*Tax & shipping not included - Lead times subject to change.*

*Footing anchors & decking fasteners not included unless noted.*

# ROOFING OPTIONS

## Shingles



Shakewood



Pewter Gray



Slate

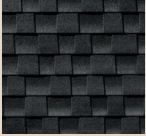

Charcoal



Barkwood



Weathered Wood

### Pine Shingle Options:

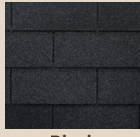

Black

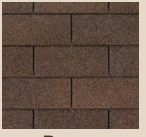

Brown

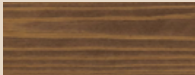

Oxford Brown

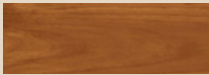

Sierra



Timberline



Cedar Natural



Redwood

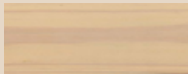

White Birch

## Metal



Black

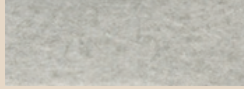

Galvalume



Barn Red



Cocoa Brown



Charcoal Gray

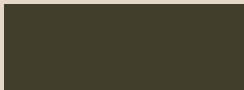

Burnished Slate

# CARPORT CONVERSIONS



## Stain Color Variation Disclaimer

*Wood is a natural material with inherent variations in grain, density, moisture content, and color. As a result, stain colors may vary from samples, swatches, or prior projects.*

*Final stain appearance may be affected by multiple factors including, but not limited to, wood species, age, moisture content, application method, lighting conditions, and environmental exposure.*

*We do not guarantee an exact match to any stain sample or color representation.*

# 3D, Post Footprint Sketches & Instructions

*After deposit, we create a full 3D model and a post-layout footprint with dimensions and spacing.*

*Written install instructions are emailed and included at delivery*

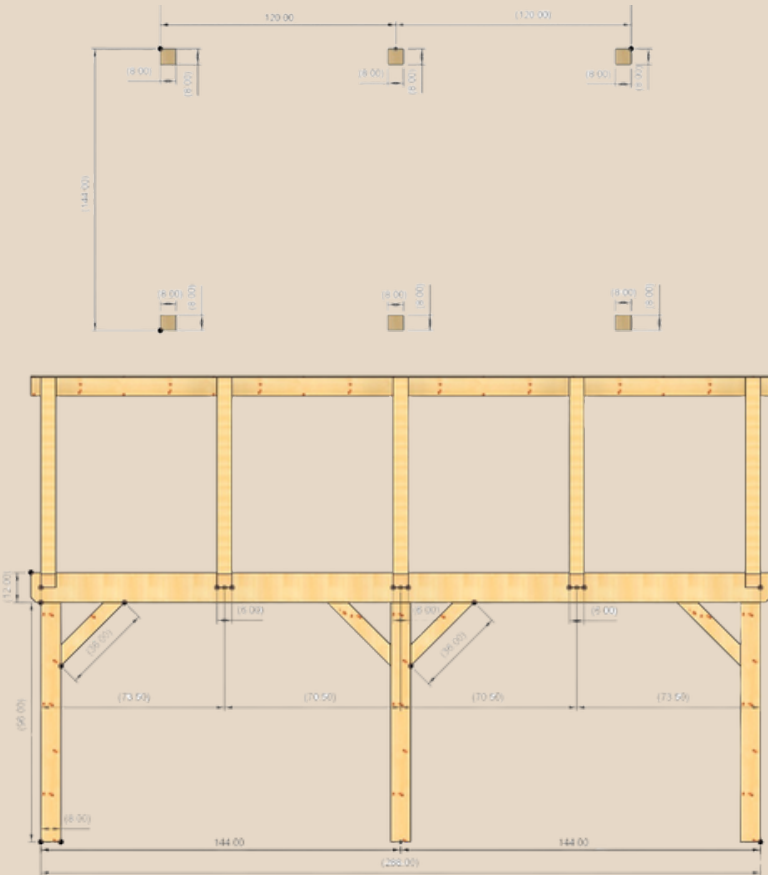

## ***Engineering & Structural Disclaimer***

*All standard kits are designed and proportioned in accordance with typical loading requirements for Tennessee and surrounding regions based on industry standards for heavy timber construction.*

*If site-specific engineering is required due to geographic location, local building codes, or permitting requirements, stamped structural drawings and calculations can be provided for an additional fee of \$2,500.*

# ROOF DECKING

Our roof systems feature kiln-dried Southern Yellow Pine tongue-and-groove decking, selected for strength, stability, and appearance. Each board is milled to 1.5" thickness with a 6.75" face width and finished to a #1 grade with a refined v-joint edge detail.

This precision-fit system not only provides a durable and structurally integrated roof deck, but also creates a seamless, high-end wood ceiling from below.



# PROTECTIVE PLATE FINISHES

Our steel connector plates are finished with premium powder-coated or DTM (direct-to-metal) systems, selected to match the performance requirements of each individual project. Engineered for demanding outdoor applications, these high-performance coatings provide exceptional resistance to corrosion, moisture, and environmental exposure.

In addition to their protective qualities, our finishes are applied with a focus on visual consistency and detail, offering a smooth, refined appearance that enhances the overall design of the structure. The result is a connector system that not only performs under pressure but also contributes to a polished, high-end look—delivering long-term durability, reliability, and lasting value.

# SHIPMENT

Upon completion, all materials are securely palletized and prepared for freight shipment. Timber Frame Solutions manages shipping coordination to your project site. Clients are responsible for providing equipment to offload materials upon delivery.

Offload logistics are confirmed in advance, with driver and client contact details shared to ensure clear communication and a seamless delivery experience.



# PAYMENT TERMS

- **50/50 plan: 50% deposit to start, 50% due before shipment.**
- **Full balance required before freight is loaded.**
- **Accepted: cash, check, card, Apple/Google Pay, ACH.**

# PAST PROJECTS



📞 309-825-7164

✉️ [tennesseetimberproducts@gmail.com](mailto:tennesseetimberproducts@gmail.com)

📞 740-572-6195

📍 713 HWY 45, Henderson, TN 38340